

sku #21612

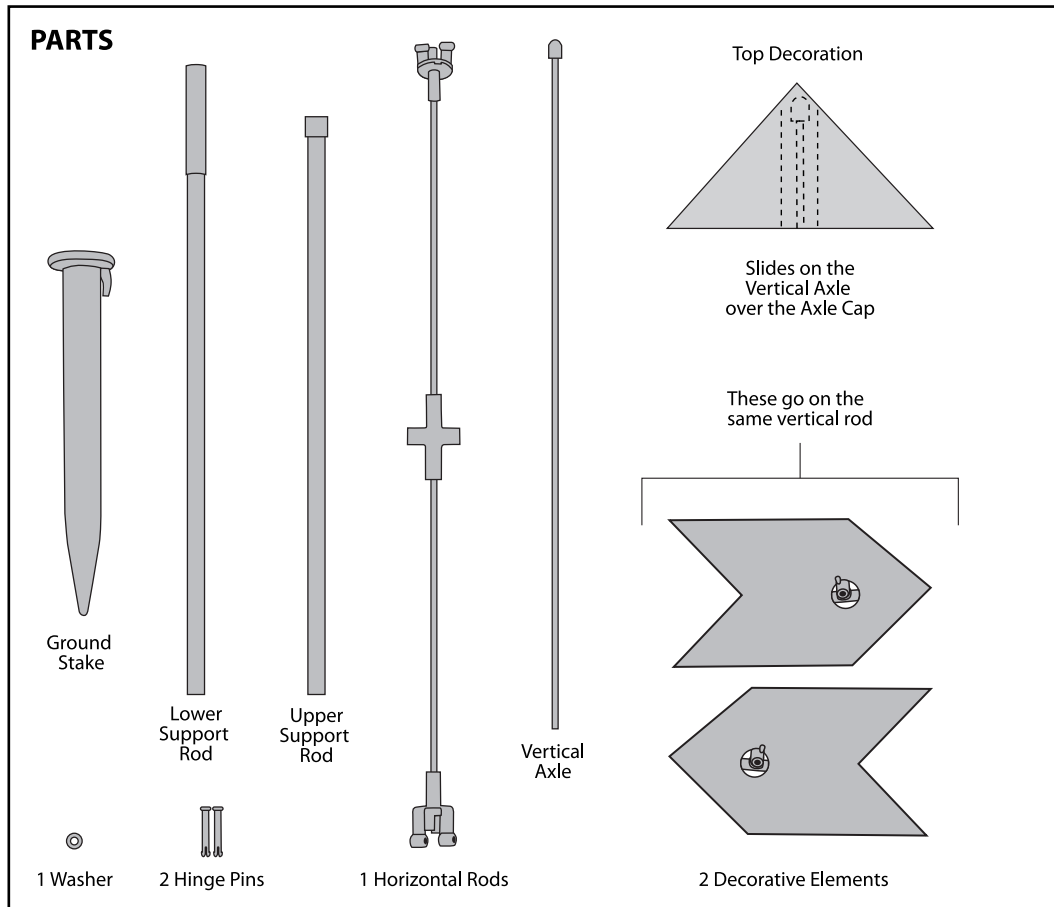

**Step 1**

Insert the Hinge Pin into Hinge on each Decorative Element to attach it to the Horizontal Rod. Make sure that the Decorative Element is not upside down when you attach it. The spinner will not spin properly if the Decorative Elements are upside down. The Decorative Elements should face opposite directions on the end of the Horizontal Rod. (Diagrams A & B)

**Step 2**

Slide the Hub and Washer onto the Vertical Axle so that the Hub sits on top of the Washer. Slide Vertical Axle into Upper Support Rod. (Diagram C & D)

**Step 3**

Insert the Vertical Axle into the opening in the bottom of the Top Decoration. (Diagram D)

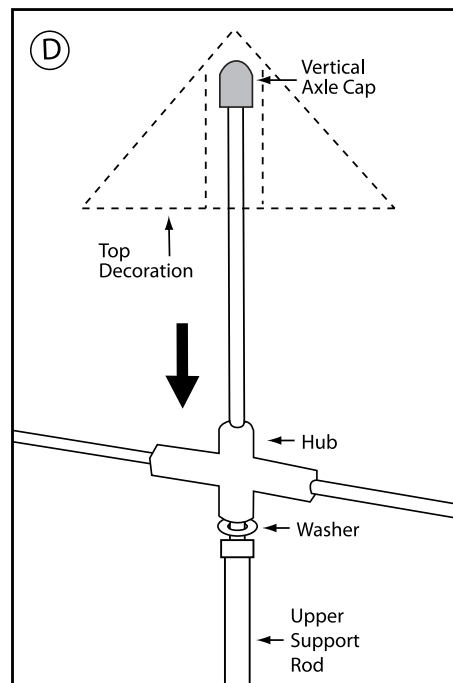
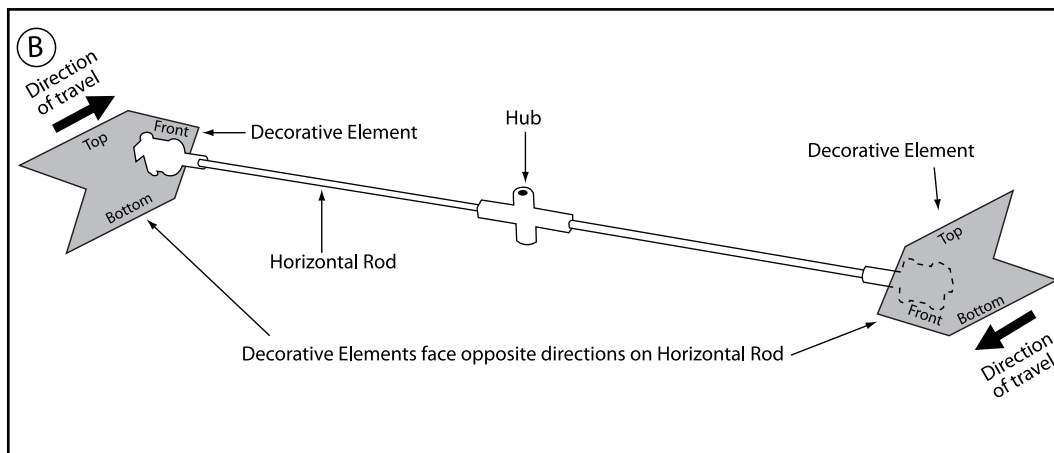
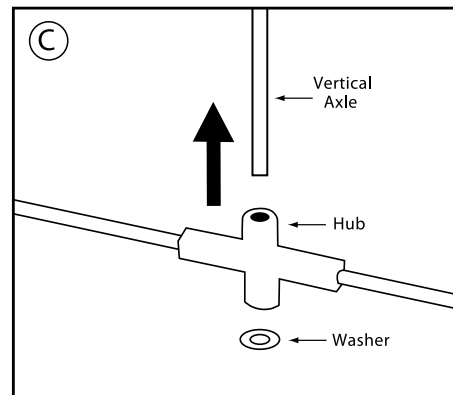
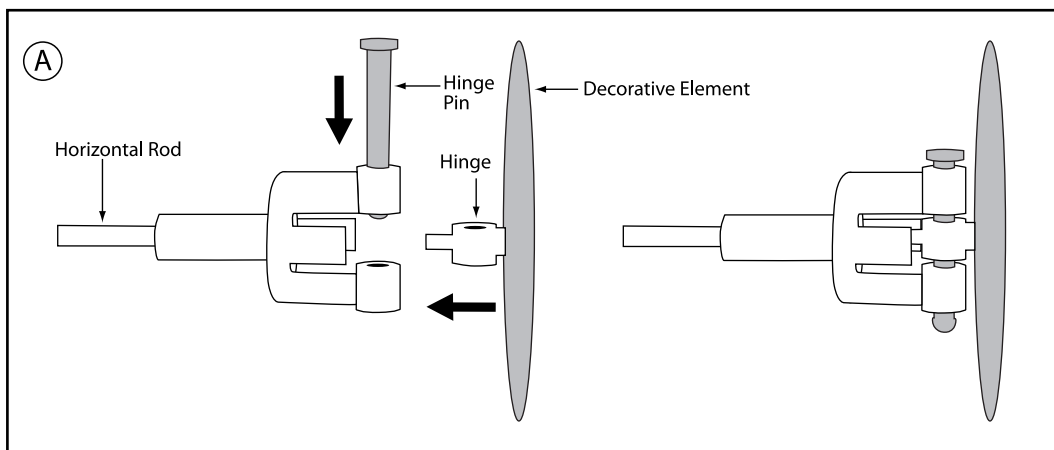

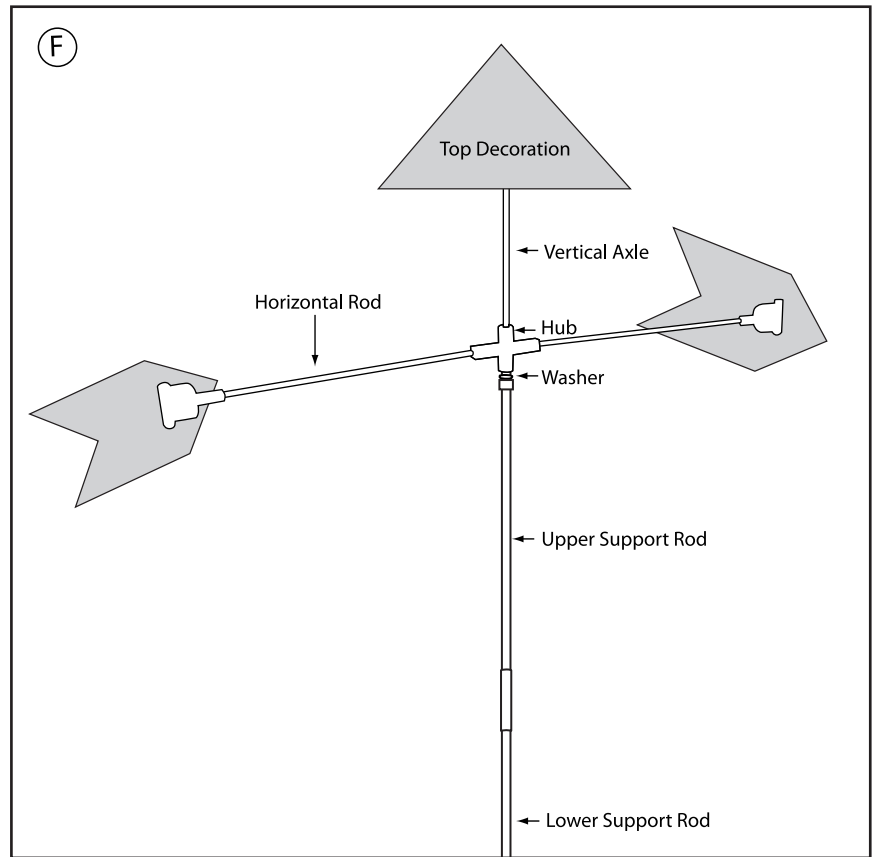
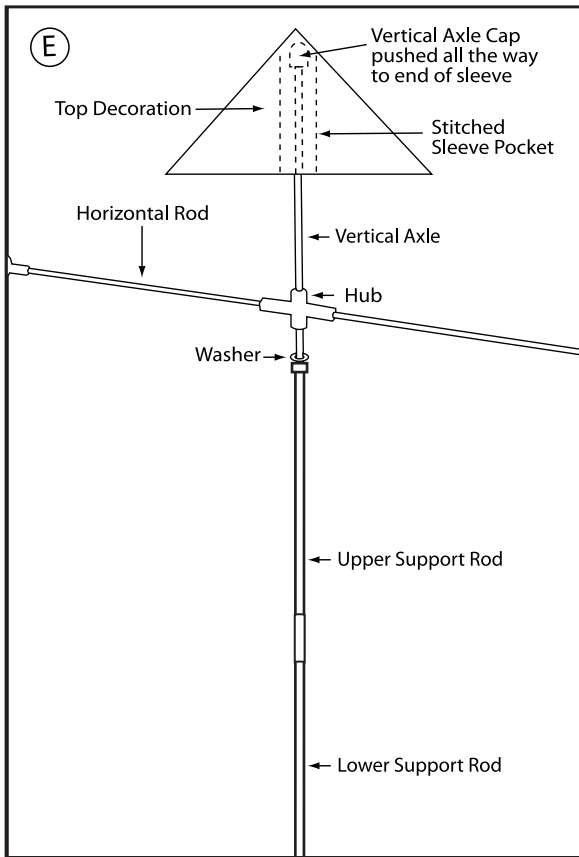

#### Step 4

Stick the Vertical Axle into Upper Support Rod. (Diagram G) Stick the Upper Support Rod into the Lower Support Rod. (Diagram G) The Vertical Axle will come to rest by an Internal Stop inside the Upper Support Rod. The Vertical Axle is held in place by gravity. For more permanent installations you may glue the Vertical Axle into the Upper Support Rod.

#### Step 5

Drive Ground Stake into ground and insert the Support Pole of assembled Carousel Spinner into the Ground Stake. (Diagram H)

You are now ready to enjoy your Single Tier Carousel Spinner!

**PLEASE NOTE: It is recommended that you take your Single Tier Carousel Spinner inside during storms and harsh weather to preserve its durability.**

